

- ▶ Templates
- ▶▶ Drilling templates

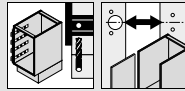

Universal individual template

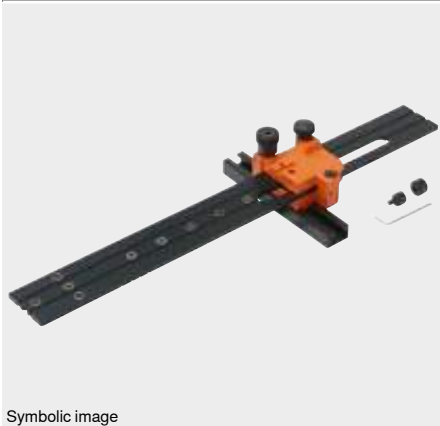

Symbolic image

- Template for pre-drilling the fixing positions for cabinet profiles, lift mechanisms, mounting and adapter plates
- The template can be used with assembled and unassembled cabinets
- Depth position setting using calibration
- Suitable for overlay and inset applications
- For system and chipboard screws
- Assembly on a marking line
- Material: nylon/steel/aluminium

Assembly possibilities

AVENTOS	TANDEMBOX antaro
CLIP top BLUMOTION	TANDEMBOX plus
CLIP top	METABOX
MODUL	MOVENTO
LEGRABOX	TANDEM
TANDEMBOX intivo	STANDARD

Page instructions

Overview – templates	734
Overview – assembly possibilities	736



Application video

Order information

Description	Part no.
Universal individual template	65.1051.02
Composed of:	
- 1 x Universal individual template	
- 1 x Drilling depth spacer Ø 5 mm	
- 1 x Reducing bush Ø 5 to Ø 2.5 mm	
- 1 x Allen key	

Accessories

Description	Part no.
 Add-on for SPACE CORNER	65.1107

Assembly possibilities

AVENTOS

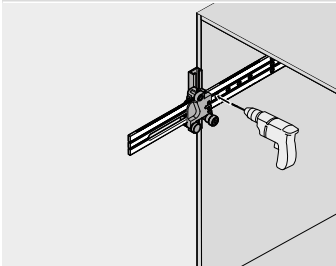

Cabinet assembly

- Set template depth position using the calibration
- Position template in cabinet on marking line
- Pre-drill fixing positions for lift mechanism pegs

CLIP top BLUMOTION/CLIP top/MODUL

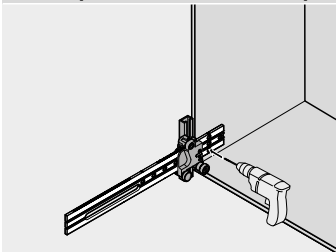

Hinge system assembly

- Set template depth position using the calibration
- Position template on marking line
- Pre-drill fixing positions for mounting and adapter plates (BLUMOTION/TIP-ON for doors)

LEGRABOX pure/LEGRABOX free/TANDEMBOX intivo/TANDEMBOX antaro/TANDEMBOX plus/METABOX/MOVENTO/TANDEM/STANDARD

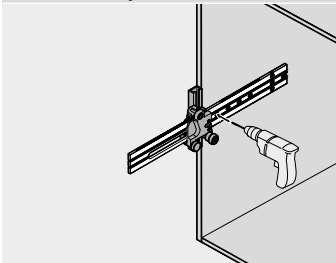

Cabinet assembly

- Set template depth position using the calibration
- Position template on marking line
- Pre-drill fixing positions for cabinet profiles
- Pre-drill fixing positions for BLUMOTION for METABOX
- The additional part (65.1107) enables SPACE CORNER assembly